

PART NO. AS5000057
REV.

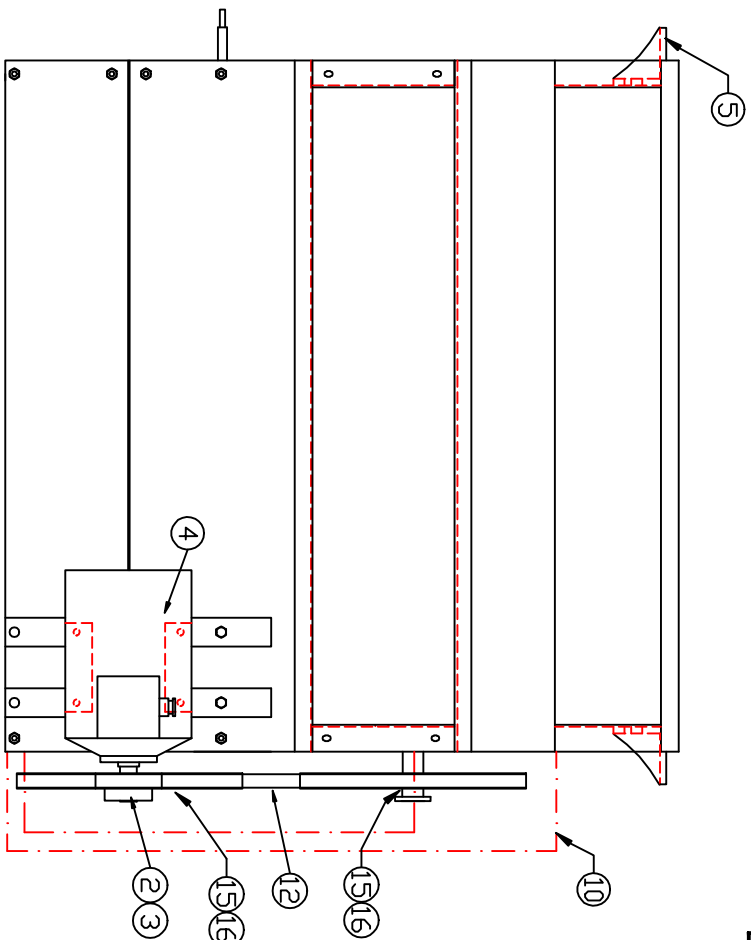
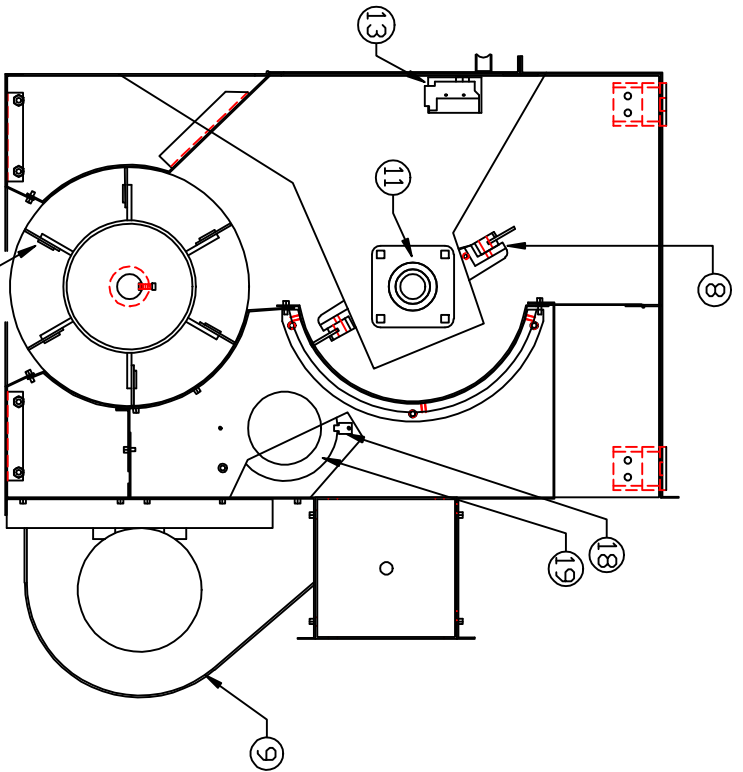

ITEM	REQ'D.	PART NO.	DESCRIPTION
20	-	---	---
19	2	P50000175	PLEXIGLASS COVER
18	4	P35000042	SPRING FASTENERS
17	-	---	---
16	2	P20000008	H-1 7/16" BUSHING
15	2	P19000156	BK130H SHEAVE
14	-	---	---
13	1	PUS016076	BZE6-2RQ MICRO SW.
12	1	P15000052	B82 BELT
11	2	P16000186	FY 1 7/16 WM (SKF)
10	1	SS0000350	D-106 GUARD
9	1	P50000309	MOTOR COVER
8	1	SS0000581	FLAT DIFFER ASS'Y 36"
7	6	F50000195	NEOPRENE BLADE HOLDER
6	6	F50000192	NEOPRENE BLADE
5	4	F50000224	HANGING BRACKET
4	1	P22000295	SIEMENS GST4266 METRIC MOTOR
3	1	P20000115	SHx24mm BUSHING
2	1	P19000197	1B34SH SHEAVE
1	1	SS0000821	D-106 SUB ASS'Y

FILE	TOLERANCES UNLESS OTHERWISE SPECIFIED
APR.	FRACTIONAL & DECIMAL & ANGLES
DEC.	FRACTIONAL & DECIMAL & ANGLES
DATE	11-9-99

MTL	FRSH
-----	------

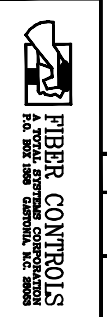

NAME	36"
DESCRIPTION	D-106 MAIN ASSEMBLY
PART NO.	AS5000057

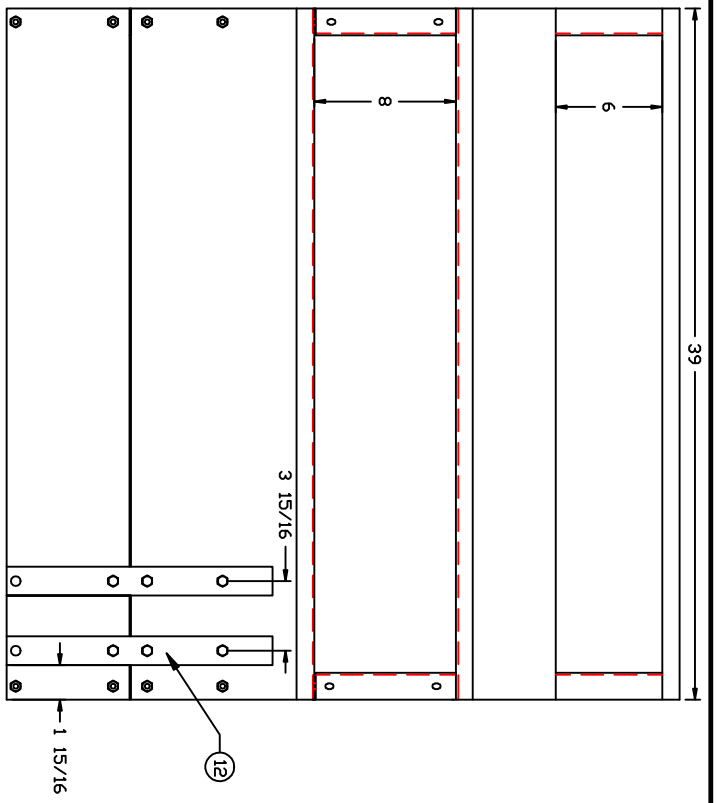
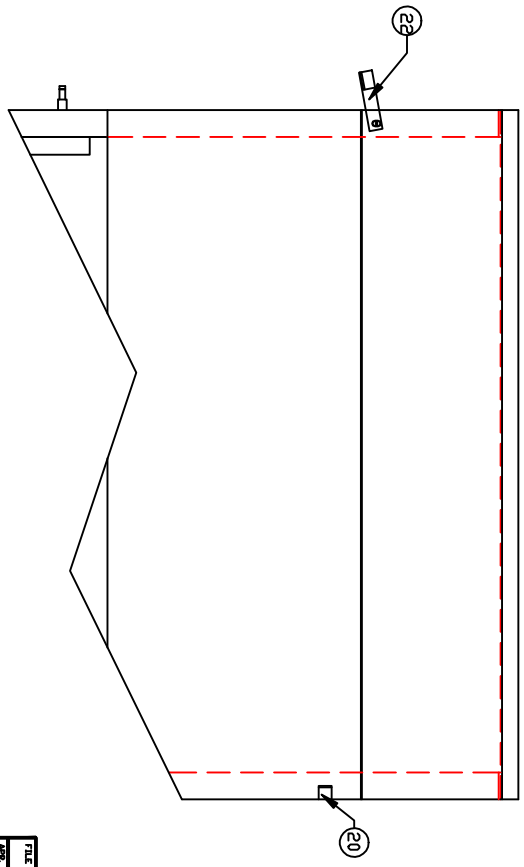
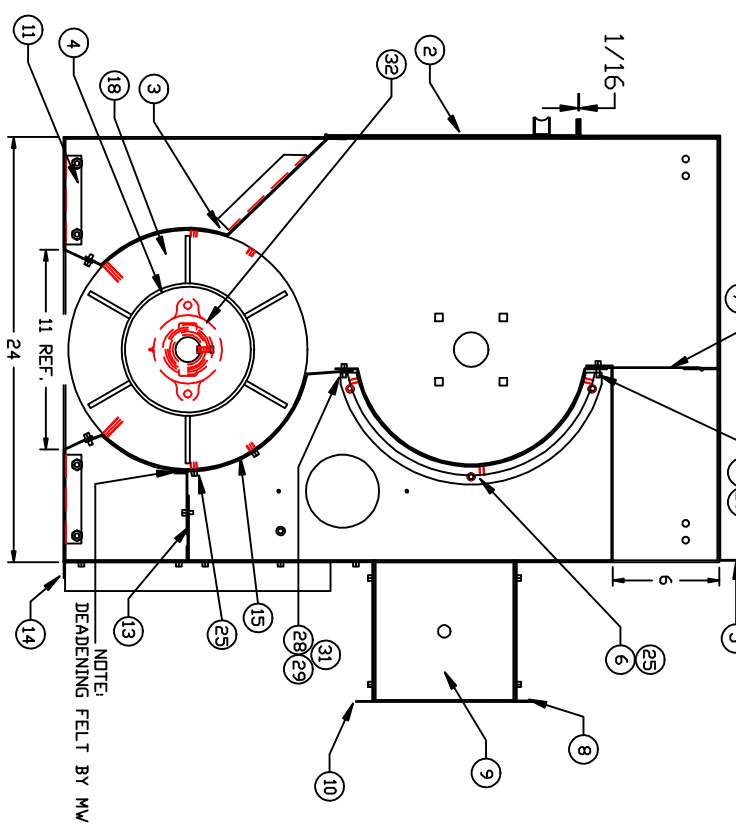

PART NO. S50000821
REV.

ITEM	REQ'D	PART NO.	DESCRIPTION
21	1	F50000160	RH DDDR LATCH
20	1	F50000170	FILE IN
19	32	P38620006	3/8" LOCK WASHER
18	2	S50000451	DIFFER HEAD
17	10	P38580420	1/4"-20 LOCK NUT
16	10	P38870408	1/4"-20X1/2" BH SUC. SCR.
15	1	F50000493	EXT. DIFFER COVER
14	1	F50000170	FILE IN
13	1	F50000323	EXT. DIFFER COVER BRACE
12	2	F2000146	POWER STRUT
11	2	S5000342	FILE IN ASSEMBLY
10	1	F50000161	BACK COVER
9	2	F50000176	BAFFLE BOX END
8	1	F50000547	MA/T. SLIDE ASSY
7	1	S50000234	INLET DAMPER DDDR
6	1	S50000376	INTERNAL SCREEN ASSY
5	1	S50000249	TOP COVER ASSY
4	1	S50000313	EXT. DIFFER ASSY
3	1	S50000343	EXT. DIFFER COVER
2	1	S50000139	DDDR ASSEMBLY
1	1	S50000519	D-106 RS PANEL ASSY

FILE	TOLERANCES UNLESS OTHERWISE SPECIFIED
FR.	FRACTIONAL & DECIMAL &
ANG.	ANGLE & SLOPE &
COL.	DRIVEN BY JDM
DATE	11-11-99

MTL.	FRSH
------	------

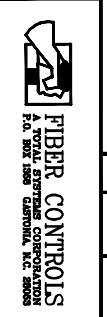

NAME	36"
DESCRIPTION	D-106 SUB ASSEMBLY
PART NO.	S50000821