

ITEM	REQ'D	PART NO.	DESCRIPTION
1	1	SS3000417	D-130 SUB. ASS'Y
2	1	SS3000415	FLAT DIFFER ASS'Y
3	2	PS5000175	6" PLEXIGLASS COVER
4	6	FS3000416	ROUND DIFFER BLADE
5	6	FS2000153	BLADE RETAINER
6	1	FS3000134	DRIVE GUARD
7	1	FS3000135	DRIVE GUARD COVER
8	1	P19000085	2TB20.0 SHEAVE
9	1	PE2000054	2S17 1 7/16 BUSHING
10	2	PE2000137	MOTOR 2 HP.1800RPM/460V
11	2	P19000066	2TB4.2 SHEAVE
12	2	PE2000013	P1-1 1/8 BUSHING
13	2	P15000059	BELT B-97
14	2	P16000039	PCJN - 1 7/16 BEARING
15	4	P35000042	SPRING FASTENER
16	16	P38620006	3/8 LOCK WASHER
17	36	P384000410	1/4-20X 5/8 H.H. BOLT
18	16	P38600006	3/8 FLAT WASHER
19	16	P38620006	3/8 LOCK WASHER
20	16	P386800416	3/8-16 NUT
21	36	P38600004	1/4 FLAT WASHER
22	36	P38620004	1/4 LOCK WASHER
23	1	SS3000294	MOTOR BASE ASS'Y
24	2	P15000041	BELT B-67
25	1	SS3000190	MOTOR GUARD
26	1	P19000016	2B124 SHEAVE
27	6	P38400612	3/8-16X3/4 H.H. BOLT
28	1	S90000180	SWITCH ASS'Y
29	1	PE2000040	Ø1 1 7/16 BORE
30	1	FS3000295	FRONT MOTOR COVER
31	1	FS3000307	BEARING/SHAFT GUARD
32	4	P33000116	LATCH AT-11-702-20
33	1	SS3000361	JUNCTION BDX

LETTER	REVISION	REV BY	DATE

TITLE	TOLERANCES UNLESS OTHERWISE SPECIFIED	M.T.L.
DATE	FRACTIONAL & DECIMALS	FRACTION
APP'D	FRACTIONAL & DECIMALS	FRACTION
DESIGNED BY	SCALE 1=1	
DRAWN BY	JJM	
CHECKED BY		
DATE	4-9-97	

FIBER CONTROLS
A TYPICAL SPINNING CORPORATION
P.O. BOX 2899 CLEVELAND, OH 44109

NAME: **D-130 X 54"**

PART NO.: **AS300013**

PART NO.
SS3000417
REV.

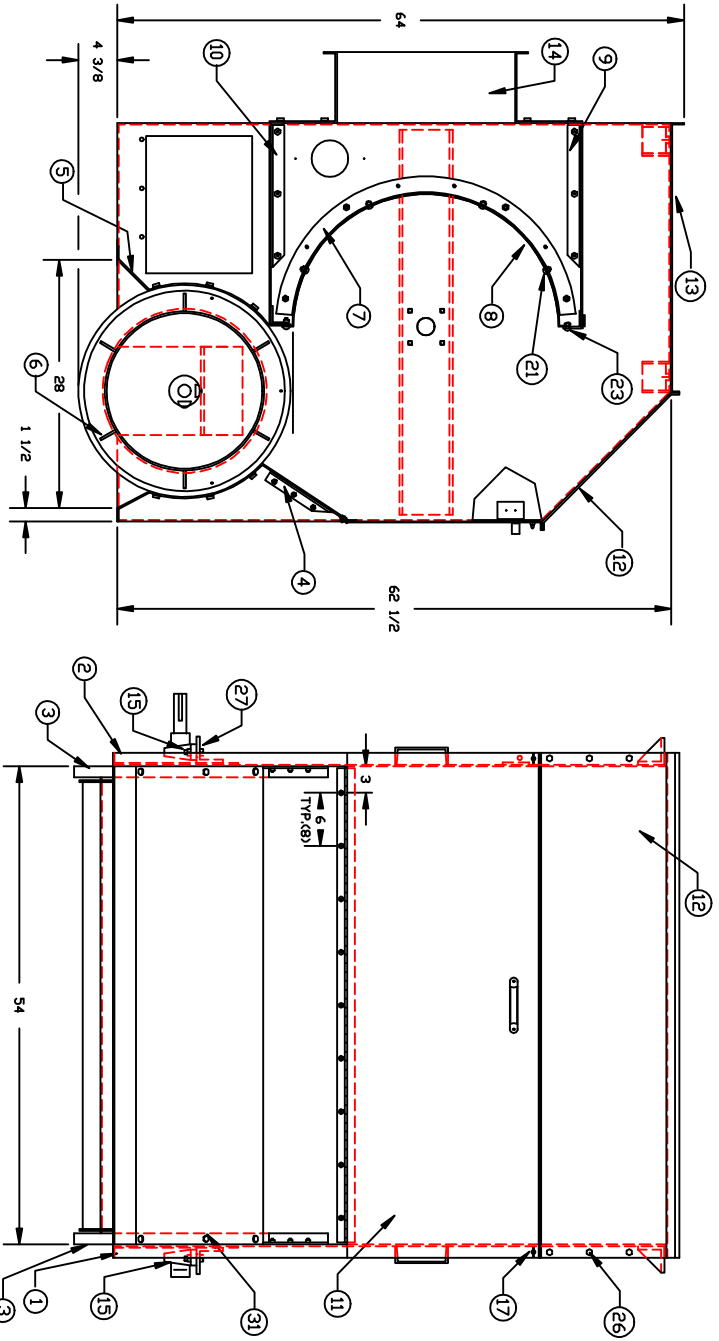

ITEM	QTY	PART NO.	DESCRIPTION
1	1	SS3000175	R.H. SIDE PANEL ASS'Y
2	1	SS3000176	L.H. SIDE PANEL ASS'Y
3	2	P53000148	EXTERNAL DIFFER HEAD
4	1	SS3000204	EXTERNAL DIFFER SLIDE
5	1	F53000203	EXTERNAL DIFFER COVER
6	1	SS3000195	EXTERNAL DIFFER ASS'Y
7	2	F53000104	INT. SCREEN CHECK
8	1	F53000207	DIFFER SCREEN
9	1	SS3000208	INLET COVER ASS'Y
10	1	SS3000220	OUTLET COVER ASS'Y
11	1	SS3000211	DIFFER ASSEMBLY
12	1	SS3000418	FRONT TOP COVER ASS'Y
13	1	F53000210	TOP COVER
14	2	F53000118	BAFFEL END PIECE
15	2	P16000054	BEARING RAK 1 7/16
16	-	---	---
17	2	P38470420	1/4-20 WING NUT
18	8	P38870616	3/8-16X1 BUT. HD. SCR.
19	24	P38620006	3/8 LOCK WASHER
20	8	P38500616	3/8-16 LOCK NUT
21	15	P38870408	1/4-20X1/2 BUT. HD. SCR.
22	36	P38580420	1/4-20 LOCK NUT
23	32	P38870412	1/4-20X3/4 BUT. HD. SCR.
24	78	962000004	1/4-20 HEX NUT
25	78	P38500420	1/4 B.S. LOCK WASHER
26	66	P38400412	1/4-20X3/4 H.H. CAP SCE.
27	4	P38400832	1/2-13X2 H.H. BOLT
28	4	P38500813	1/2-13 HEX NUT
29	4	P38620008	1/2 LOCK WASHER
30	4	P38600008	1/2 FLAT WASHER
31	18	P38400612	3/8-16X3/4 H.H. BOLT
32	2	P38400408	1/4-20X1/2 H.H. BOLT
33	-	---	---
34	2	P38600004	1/4 B.S. FLAT WASHER

LETTER	REVISION	REV. BY	DATE

FILE	TOLERANCES UNLESS OTHERWISE SPECIFIED
DATE	FRACTIONAL & DECIMAL
APP.	SCALE 1:10
CHK.	DRAWN BY JJM
DES.	DATE 4-9-97

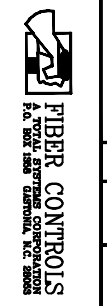

NAME	D-130
SUB. ASS'Y	54'
MOQ.	D-130
PART NO.	SS3000417