

PART NO. AS3000014
REV. 4

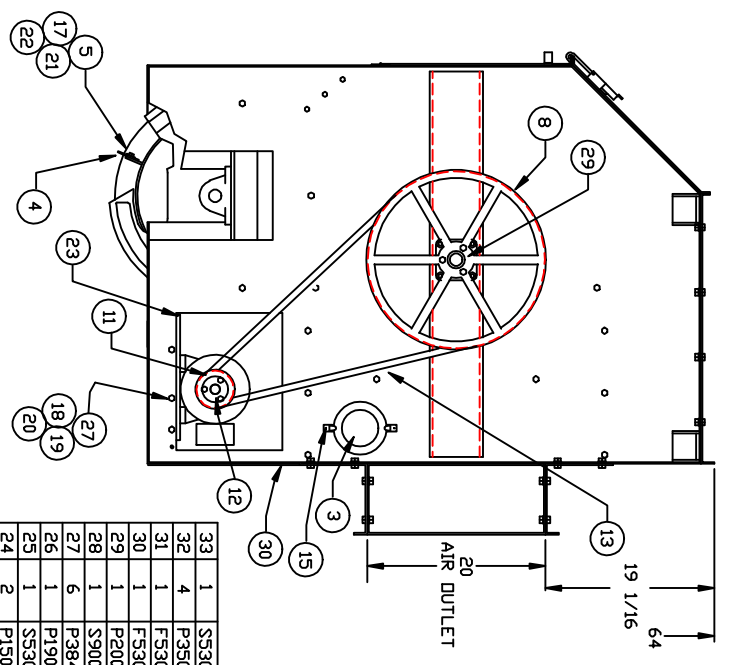
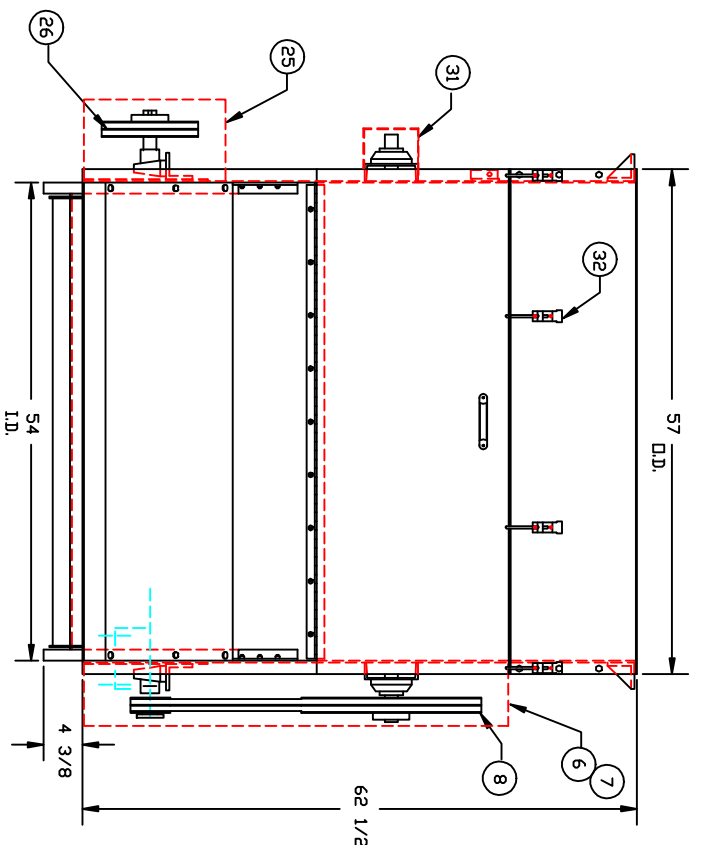

ITEM	REQ'D.	PART NO.	DESCRIPTION
33	1	SS3000361	JUNCTION BDX
32	4	P35000116	LATCH AT-11-702-20
31	1	FS3000307	BEARING/SHAFT GUARD
30	1	FS3000295	FRONT MOTOR COVER
29	1	PE2000040	Ø1 1 7/16 BORE
28	1	S90000180	SWITCH ASS'Y
27	6	P38400612	3/8-16X3/4 HH. BOLT
26	1	P19000016	2B124 SHEAVE
25	1	SS3000190	MOTOR GUARD
24	2	P15000041	BELT B-67
23	1	SS3000294	MOTOR BASE ASS'Y
22	36	P38620004	1/4 LOCK WASHER
21	36	P38600004	1/4 FLAT WASHER
20	16	P38680046	3/8-16 NUT
19	16	P38620006	3/8 LOCK WASHER
18	16	P38600006	3/8 FLAT WASHER
17	36	P38400410	1/4-20X 5/8 HH. BOLT
16	8	P38040556	3/8-16X3 1/2 CARR. BOLT
15	4	P35000042	SPRING FASTENER
14	2	P16000039	PCJN - 1 7/16 BEARING
13	2	P15000059	BELT B-97
12	2	PE20000013	P1-1 1/8 BUSHING
11	2	P19000066	2TB4.2 SHEAVE
10	2	PE2000137	MOTOR 2 HP.1800RPM/460V
9	1	PE20000054	2S17 1 7/16 BUSHING
8	1	P19000085	2TB20.0 SHEAVE
7	1	FS3000135	DRIVE GUARD COVER
6	1	FS3000134	DRIVE GUARD
5	6	FS2000153	BLADE RETAINER
4	6	FS3000416	ROUND DDFEER BLADE
3	2	PS0000175	6" PLEXIGLASS COVER
2	1	SS3000421	FLAT DDFEER ASSY 3/16-1/4
1	1	SS3000422	D-130 SUB. ASSY

LETTER	REVISION	REV BY	DATE

FILE	TOLERANCES UNLESS OTHERWISE SPECIFIED	M.T.L.
DATE	FRACTIONAL & DECIMAL .1=1	FRAISE
APP	DRAWN BY JDM	
CHK	DATE 4-15-98	
COA		

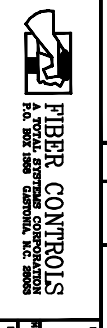

NAME: HVD-130 X 54"
PART NO. AS3000014

PART NO.
SS3000422
REV.

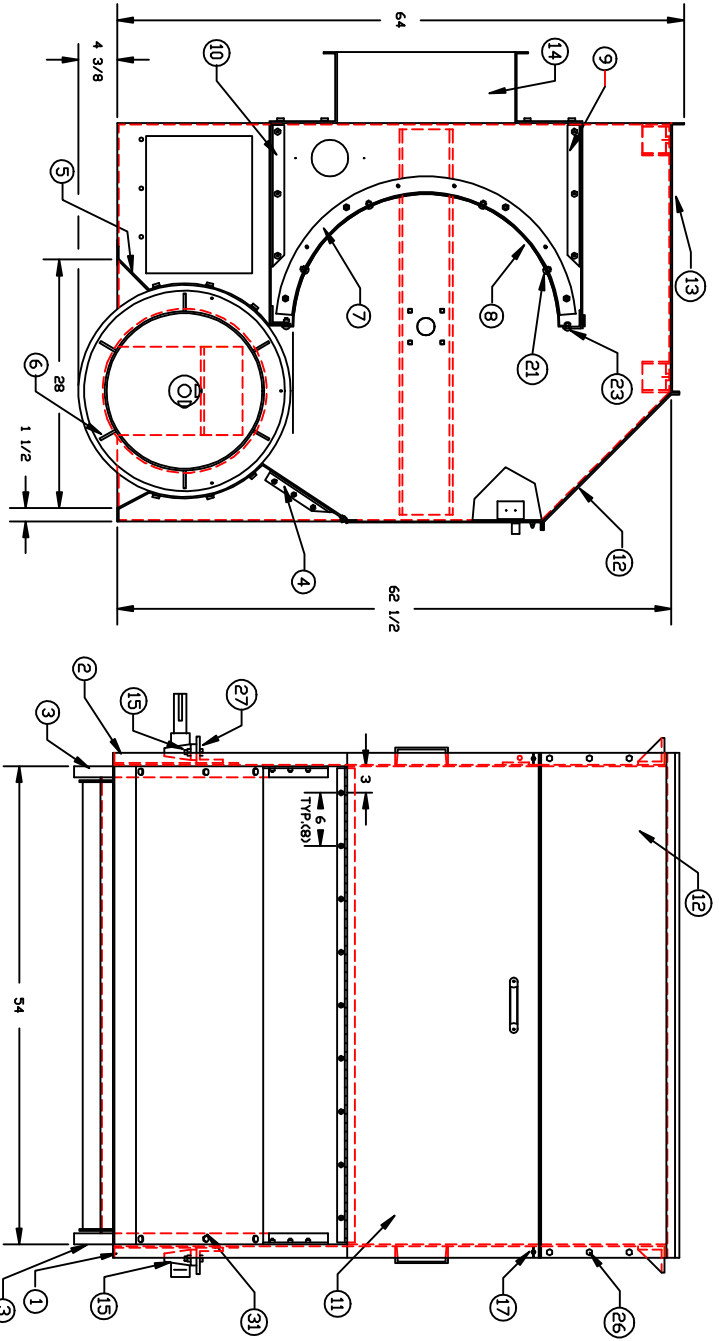

ITEM	REQ'D.	PART NO.	DESCRIPTION
34	2	P38600004	1/4 B.S. FLAT WASHER
33	-	---	---
32	2	P38400408	1/4-20X1/2 HH. BOLT
31	18	P38400612	3/8-16X3/4 HH. BOLT
30	4	P38600008	1/2 FLAT WASHER
29	4	P38620008	1/2 LOCK WASHER
28	4	P38500813	1/2-13 HEX NUT
27	4	P38400832	1/2-13X2 HH. BOLT
26	66	P38400412	1/4-20X3/4 HH. CAP SCE.
25	78	P38500420	1/4-20 HEX NUT
24	78	P38620004	1/4 B.S. LOCK WASHER
23	32	P38870412	1/4-20X3/4 BUT. HD. SCR.
22	36	P38580420	1/4-20 LOCK NUT
21	15	P38870408	1/4-20X1/2 BUT. HD. SCR.
20	8	P38500616	3/8-16 LOCK NUT
19	24	P38620006	3/8 LOCK WASHER
18	8	P38870616	3/8-16X1 BUT. HD. SCR.
17	2	P38470420	1/4-20 WING NUT
16	-	---	---
15	2	P16000054	BEARING RAK 1 7/16
14	2	F53000118	BAFFEL END PIECE
13	1	F53000210	TOP COVER
12	1	SS3000418	FRONT TOP COVER ASS'Y
11	1	SS3000211	DDDR ASSEMBLY
10	1	SS3000220	OUTLET COVER ASS'Y
9	1	SS3000208	INLET COVER ASS'Y
8	1	F53000401	DIFFER SCREEN
7	2	F53000104	INT. SCREEN CHEEK
6	1	SS3000195	EXTERNAL DIFFER ASS'Y
5	1	F53000203	EXTERNAL DIFFER COVER
4	1	SS3000204	EXTERNAL DIFFER SLIDE
3	2	F53000509	EXTERNAL DIFFER HEAD
2	1	SS3000176	L.H. SIDE PANEL ASS'Y
1	1	SS3000175	R.H. SIDE PANEL ASS'Y

LETTER	REVISION	REV. BY	DATE

FILE	TOLERANCES UNLESS OTHERWISE SPECIFIED
DATE	FRACTIONAL & DECIMAL
APP.	MINOR & MAJOR
CHK.	SCALE: 1"=1'-0"
DES.	DRAWN BY: JDM
	DATE: 4-15-98

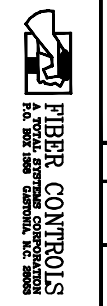

NAME	D-130
SUB. ASS'Y	54'
MOQ.	D-130
PART NO.	SS3000422