

NOTE:  
THIS MACHINE HAS  
COATED INT. SCREEN,  
FLAT DIFFER TO RUN 175 RPM  
Rd. DIFFER TO RUN 175 RPM

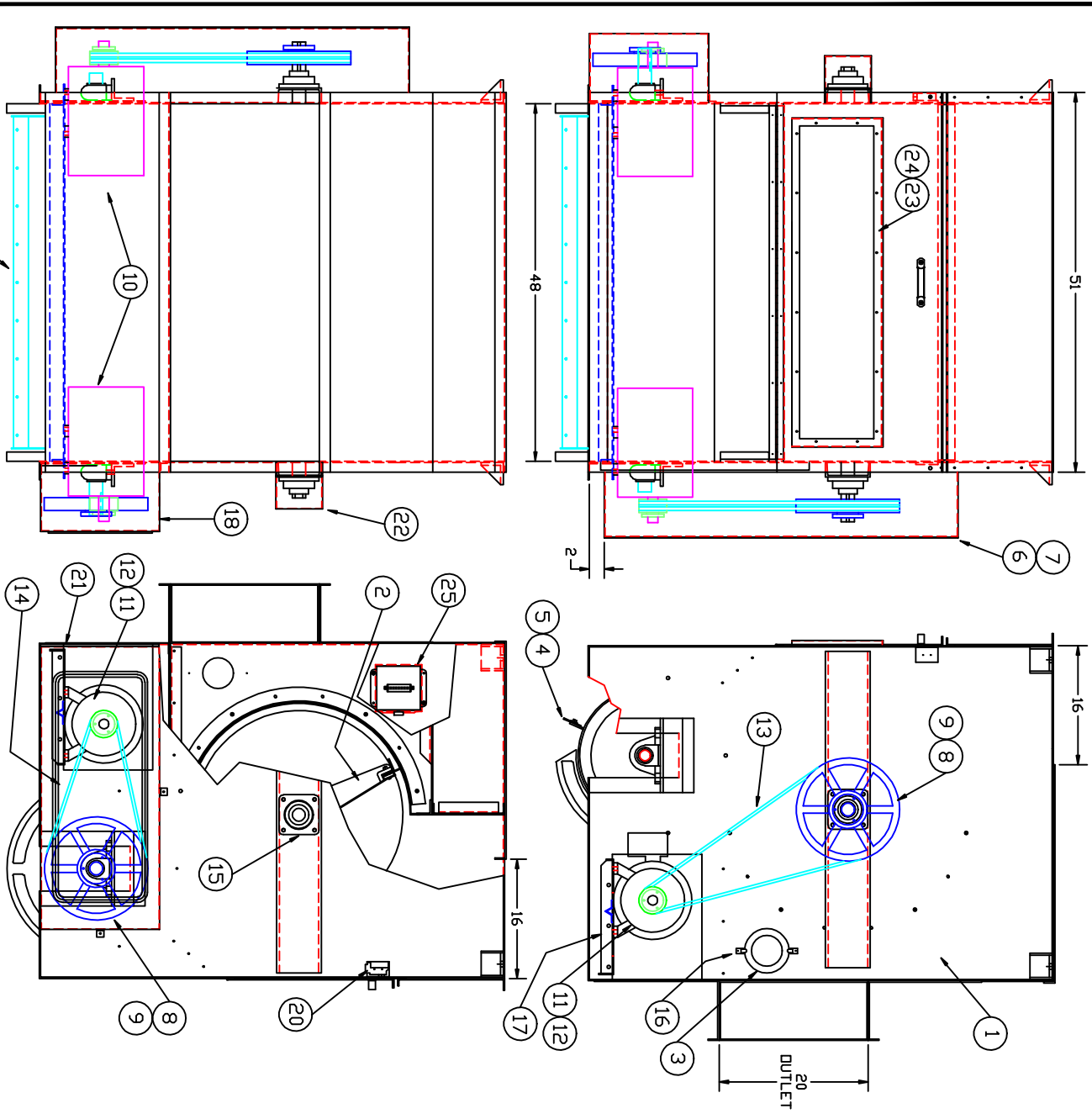

ITEM	REQ'D.	PART NO.	DESCRIPTION
40	-	---	---
39	-	---	---
38	-	---	---
37	-	---	---
36	-	---	---
35	-	---	---
34	-	---	---
33	6	P38400624	3/8-16x1 1/2 HH BOLT
32	36	P38400410	1/4 LOCK WASHER
31	36	P38600004	1/4 FLAT WASHER
30	16	P38680416	3/8-16 NUT
29	16	P38620006	3/8 LOCK WASHER
28	16	P38600006	3/8 FLAT WASHER
27	36	P38400410	1/4-20x5/8 HH. BOLT
26	8	P38040656	3/8-16x3.50 CARR. BOLT
25	1	SS3000361	JUNCTION BOX
24	1	P53000498	WINDOW
23	1	F53000497	WINDOW FRAME
22	1	SS3000338	BEARING SHAF-T GUARD
21	1	F53000300	FRONT MOTOR COVER
20	1	S90000180	SAFETY SWITCH ASS'Y
19	-	---	---
18	1	SS3000504	MOTOR GUARD
17	1	SS3000456	MOTOR BASE
16	4	P35000042	SPRING FASTENER
15	2	P16000060	RCJ 1 15/16 BEARING
14	2	P15000038	B-64 BELT
13	2	P15000053	B-83 BELT
12	2	P20000016	P1-1 3/8 BUSHING
11	2	P19000064	2TB 3.4 MOTOR SHEAVE
10	2	P22000279	2HP 900RPM 460V 231T MOTOR
9	2	P20000045	Q1-1 15/16" BUSHING
8	2	P19000170	2TB 13.6 SHEAVE
7	1	SS3000471	DRIVE GUARD COVER
6	1	SS3000488	DRIVE GUARD
5	6	F53000506	BLADE RETAINER
4	6	F53000505	NEPRENE BLADE
3	2	P50000175	6" PLEXIGLASS COVER
2	1	SS3000533	FLAT DIFFER ASS'Y
1	1	SS3000526	SUB ASS'Y

LETTER	REVISION	REV. BY	DATE
FILE	TOLERANCES UNLESS OTHERWISE SPECIFIED		
DATE	FRACTIONAL & DECIMAL 1:1		
APP.	DRAWN BY JIM		
CHK.	DATE 3-29-00		
MFL	MFL		
FRONT	FRONT		
FIBER CONTROLS A FIBER OPTICS CORPORATION 1000 W. 10TH ST. SUITE 100 DENVER, CO 80202			
NAME	HVD-130 x 48"		
MOQ	TOP INLET		
REV. NO.	DSPREY		
PART NO.	A53000022		

PART NO. S53000526  
REV.

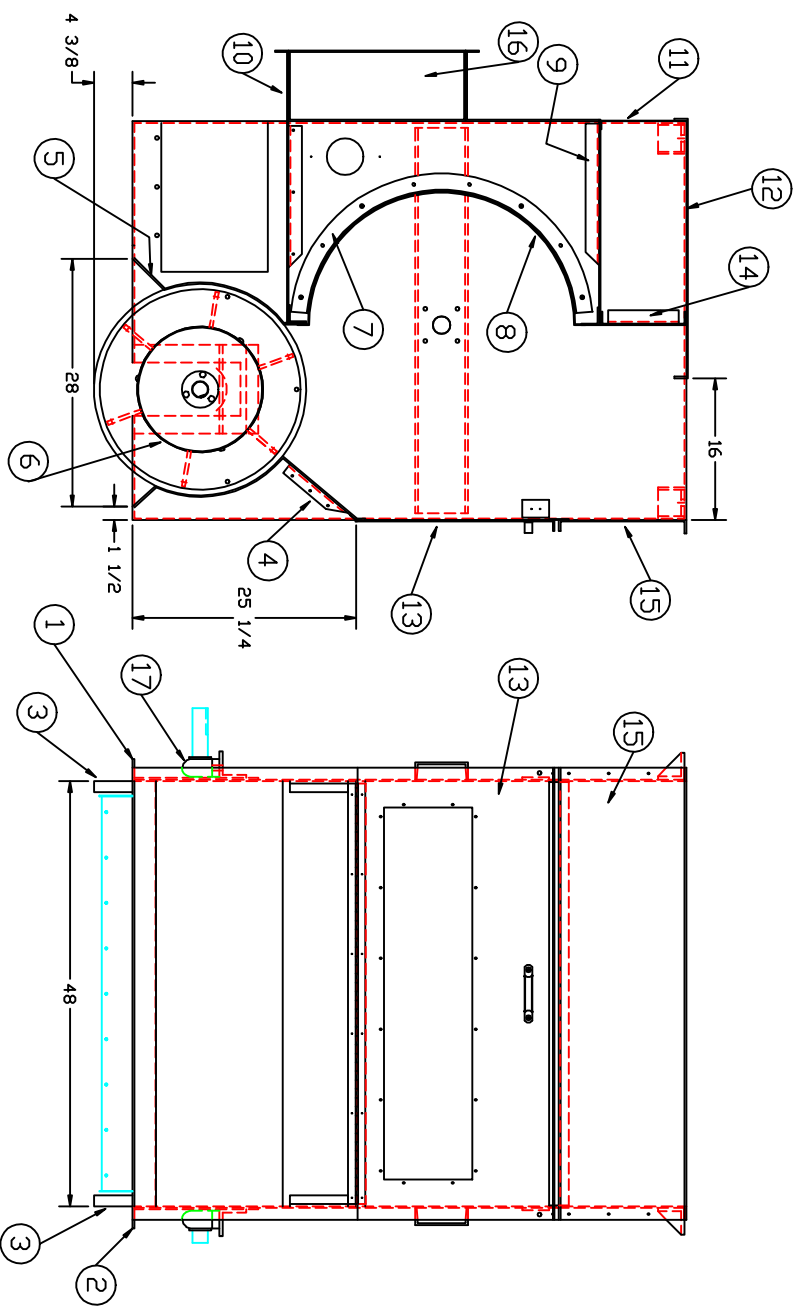

ITEM	REQ'D.	PART NO.	DESCRIPTION
40	-	---	---
39	-	---	---
38	-	---	---
37	-	---	---
36	-	---	---
35	-	---	---
34	2	P38600004	1/4 FLAT WASHER
33	2	P38400408	1/4-20x1/2 HH. BOLT
32	18	P38400612	3/8-16x3/4 HH. BOLT
31	4	P38600008	1/2 FLAT WASHER
30	4	P38620008	1/2 LOCK WASHER
29	4	P38500813	1/2-13 HEX NUT
28	4	P38400832	1/2-13x2 HH. BOLT
27	66	P38400412	1/4-20x3/4 HH. CAP SCR.
26	78	P38500420	1/4-20 HEX NUT
25	78	P38620004	1/4 B.S. LOCK WASHERS
24	32	P38870412	1/4-20x3/4 BUT. HD. SCR.
23	36	P38580420	1/4-20 LOCK NUT
22	15	P38870408	1/4-20x1/2 BUT. HD. SCR.
21	8	P38500616	3/8-16 LOCK NUT
20	24	P38620006	3/8 LOCK WASHERS
19	8	P38870616	3/8-16x1 BUT. HD SCR
18	-	---	---
17	2	P16000056	RAK 1 15/16 BEARING
16	2	F53000118	BAFFLE END PIECE
15	1	S53000508	TDP BACK COVER ASS'Y
14	1	S53000622	INLET COVER INSIDE
13	1	S53000496	CLEANOUT DDDR ASS'Y
12	1	F53000499	TDP FRONT COVER
11	1	F53000289	INLET COVER
10	1	S53000481	OUTLET COVER ASS'Y
9	1	S53000494	INLET COVER ASS'Y
8	1	F53000120	INT. SCREEN CLATED
7	2	F53000104	INT. SCREEN CHEEK
6	1	S53000370	EXTERNAL DIFFER ASS'Y
5	1	F53000152	EXTERNAL DIFFER COVER
4	1	S53000153	EXTERNAL DIFFER SLIDE
3	2	F53000319	EXTERNAL DIFFER HEAD
2	1	S53000535	RH SIDE PANEL
1	1	S53000534	LH SIDE PANEL

LETTER	REVISION	REV. BY	DATE

FILE	TOLERANCES UNLESS OTHERWISE SPECIFIED
DWG	FRACTIONAL & DECIMAL S
APP	FRACTION S
DATE	DATE
DES	DATE
	3-29-00

MTL	FRSH
-----	------

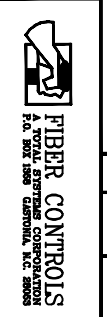

NAME	HVD-130 x 48"
SUB ASS'Y	W/SP. SCREEN
MOQ	A53000022
MA	DSFREY
PART NO.	S53000526